

1003**Extra Large head hole filling (Plia, multigrip, vibration resistant, higher strength)**

Rivet body: Aluminum (AlMg2.5)

Mandrel: Steel, RoHS surface treatment

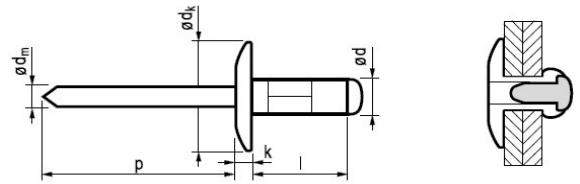

Ød * Drill hole mm	l: length (mm) +1/-0,2	Grip range mm	Part no.	Ødk mm	k mm	Ødm mm	p mm	Tensile Newton	Shear Newton	Description
4,8 [+0,05/-0,13] Ø 4,9 [5,2 max]	10,0	0,5-5,0	1002-4810	16,0 [+0/-0,5]	≤2,5	~2,78	≥27	2 350	1 500	4,8*10 Al/ST extra Large head multigrip rivet
	10,3	0,5-5,5	1003-4811							4,8*11 Al/ST extra Large head multigrip rivet
	12,0	2,0-7,0	1003-4812							4,8*12 Al/ST extra Large head multigrip rivet
	14,0	4,0-9,0	1003-4814							4,8*14 Al/ST extra Large head multigrip rivet
	16,0	6,0-11,0	1003-4816							4,8*16 Al/ST extra Large head multigrip rivet
	17,0	7,0-12,0	1003-4817							4,8*17 Al/ST extra Large head multigrip rivet
	18,0	8,0-13,0	1003-4818							4,8*18 Al/ST extra Large head multigrip rivet
	20,0	10,0-15,0	1003-4820							4,8*20 Al/ST extra Large head multigrip rivet
	22,0	12,0-17,0	1003-4822							4,8*22 Al/ST extra Large head multigrip rivet
	24,0	14,0-19,0	1003-4824							4,8*24 Al/ST extra Large head multigrip rivet
	24,8	14,5-19,5	1003-4825							4,8*25 Al/ST extra Large head multigrip rivet
	27,0	16,0-22,0	1003-4827							4,8*27 Al/ST extra Large head multigrip rivet

Technical specifications:

- thanks to the larger rivet head the clinching force will be spreaded more efficiently, so the riveted material will have less deformation
- head of the rivet is aesthetic
- at the backside of the rivet has more deformation like the regular rivet, so the clinching force will be spreaded more efficiently
- after riveting the stem/mandrel of rivet fixed in the rivet body, thus it will become vibration resistant
- further advantage is the hole filling, so it is suitable for less precise/ large borehole
- next advantage is the large grip range
- it is suitable for riveting of soft material (it will not be cracked)
- deformation of the backside of the rivet is aesthetic