

1231 Dome head AL-A2 closed rivet, closed blind rivet, closed pop rivet

Rivet body: Aluminum (AlMg5)
Mandrel: Stainless steel (A2)

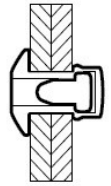
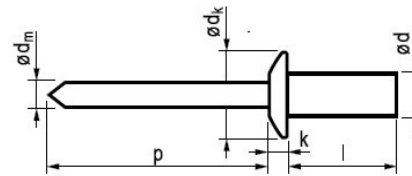

Ød * Drill hole mm	l: length (mm) +1/-0,2	Grip range mm	Part no.	Ødk mm	k mm	Ødm mm	p mm	Tensile Newton	Shear Newton	Description
3,2 [+/-0,08] Ø 3,3	6,5	0,5-2,0	1231-3206	6,0 [+/-0,24]	≤1,4	~1,70	≥27	1250	1 070	3,2'6 Dome head Aluminum/Inox closed rivet
	8,0	2,0-3,5	1231-3208							3,2'8 Dome head Al/A2 waterproof rivet
	9,5	3,5-5,0	1231-3209							3,2'9 Dome head Al/A2 closed pop rivet
	11,0	5,0-6,5	1231-3211							3,2'11 Dome head Al/A2 closed blind rivet
	12,7	6,5-8,0	1231-3212							3,2'12 Dome head Aluminum/Inox closed rivet
4,0 [+/-0,08] Ø 4,1	8,0	0,5-3,5	1231-4008	8,0 [+/-0,29]	≤1,7	~2,18	≥27	2240	1700	4,0'8 Dome head Al/A2 waterproof rivet
	9,5	3,5-4,5	1231-4009							4,0'9 Dome head Al/A2 closed pop rivet
	11,0	4,5-6,5	1231-4011							4,0'11 Dome head Al/A2 closed blind rivet
	12,7	6,5-8,0	1231-4012							4,0'12 Dome head Aluminum/Inox closed rivet
4,8 [+/-0,08] Ø 4,9	8,0	1,0-3,0	1231-4808	9,5 [+/-0,29]	≤2,0	~2,63	≥27	3100	2200	4,8'8 Dome head Al/A2 closed pop rivet
	9,5	3,0-4,5	1231-4809							4,8'9 Dome head Al/A2 closed blind rivet
	11,0	4,5-6,0	1231-4811							4,8'11 Dome head Aluminum/Inox closed rivet
	12,5	6,0-7,5	1231-4812							4,8'12 Dome head Al/A2 waterproof rivet
	14,0	7,5-9,0	1231-4814							4,8'14 Dome head Al/A2 closed pop rivet
	16,0	9,0-11,0	1231-4816							4,8'16 Dome head Al/A2 closed blind rivet
	18,0	11,0-13,0	1231-4818							4,8'18 Dome head Aluminum/Inox closed rivet
	21,0	13,0-16,0	1231-4821							4,8'21 Dome head Al/A2 waterproof rivet

Technical specifications:

- after riveting the stem/mandrel of rivet fixed in the rivet body
- airtight and waterproof (extra safe if used with silicone)
- it is good till 35 bar of pressure
- it has stronger shear/tensile strength as the regular rivets
- due to Inox stem/mandrel it is stainless