

1791**ST-ST P-LOCK high strength structural rivet with dome head (vibration resistant)**

Rivet body: Steel, RoHS surface treatment
Mandrel: Steel, RoHS surface treatment

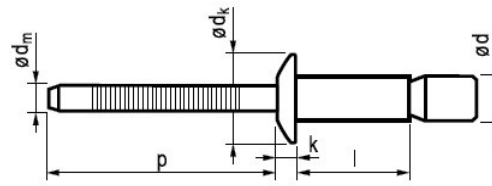

ϕd * Drill hole mm	l: length (mm) +1/-0,2	Grip range mm	Part no.	ϕd_k mm	k mm	ϕd_m mm	p mm	Tensile Newton	Shear Newton	Description
6,4 [+/-0,11] * Ø 6,6 [6,9 max]	14,0	2,0-9,5	1791-6414	13 [+/-0,35]	≤3,1	~4,0	≥27	10000	11700	6,4*14 Dome head Steel/Steel high strength
	20,0	2,0-15,9	1791-6420							6,4*20 Flat head St/St high strength rivet

Technical specifications:

- high shear and tensile strength
- during the riveting the stem/mandrel of the rivet is fixed
- waterproof rivet
- after setting, the mandrel is retained in the rivet which makes it vibration resistant (stem/mandrel will be fixed in the rivet body)
- next advantage is the hole filling, so it is suitable for less precise/ large borehole
- next advantage is the large grip range
- alternative of Avdel Monobolt (see 2771)