

9468**Small countersunk head open stainless steel cylindrical special drill size Nutsert rivet nut**

Material: Stainless steel

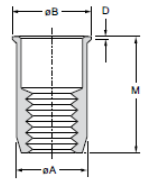

| $\varnothing d$ * Drill hole mm | M: length (mm) +0,5/-0,5 | Grip range mm | Part no. | $\varnothing B$ mm | D mm | $\varnothing A$ [+0/- 0,12] mm | Torque (Nm) | | | Description |
|------------------------------------|--------------------------------|------------------|-----------|-----------------------|------------|---|----------------|--|--|-------------------------------------|
| M3 * \varnothing 4,75 | 9,2 | 0,5-1,5 | 9468-0310 | 5,8 [+0/-0,5] | $\leq 0,9$ | 4,73 | 4,0 | | | Small Countersunk Inox M3 rivet nut |
| M4 * \varnothing 6,35 | 10,4 | 0,5-2,0 | 9468-0413 | 7,5 [+0/-0,5] | $\leq 0,9$ | 6,32 | 5,6 | | | Micro head A2 M4 rivet nut |
| M5 * \varnothing 7,15 | 11,8 | 0,5-3,0 | 9468-0514 | 8,3 [+0/-0,5] | $\leq 0,9$ | 7,11 | 11,3 | | | Small Countersunk Inox M5 rivet nut |
| M6 * \varnothing 9,53 | 14,6 | 0,8-3,2 | 9468-0619 | 10,9 [+0/-0,5] | $\leq 0,9$ | 9,50 | 16,9 | | | Micro head A2 M6 rivet nut |
| M8 * \varnothing 10,6 | 16,1 | 0,9-3,7 | 9468-0821 | 11,8 [+0/-0,5] | $\leq 0,9$ | 10,57 | 22,6 | | | Small Countersunk Inox M8 rivet nut |
| M10 * \varnothing 14,3 | 18,6 | 1,0-3,6 | 9468-1023 | 15,8 [+0/-0,5] | $\leq 1,1$ | 14,28 | 33,8 | | | Micro head A2 M10 rivet nut |

Technical specifications:

- can be set from one side, where the rear of the material and the inside of the object are inaccessible
- it is suitable for riveting of sheets and you get useable thread also
- not necessary to cut a thread or to weld a nut to the sheet (timesaving)
- material of sheet will not be deformed/ discolored
- suitable for thin sheet
- counter-boring is not necessary, despite of this the rivet nut head will stand out minimum from the surface (max. 0,5 mm)
- stainless